

AC-B1/D

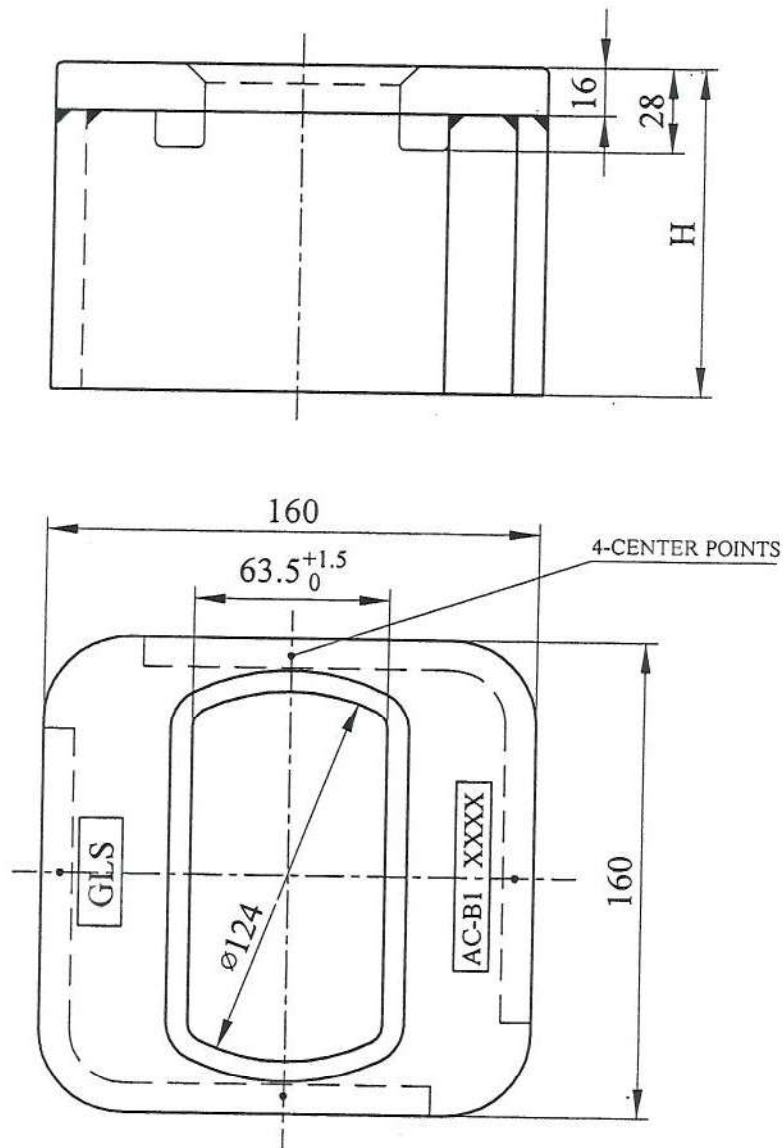

Type	H	Weight
AC-B1/D/110	110	5.8kg
AC-B1/D/130	130	6.5kg
Other height according to orders		



Material: Structural steel

Finish: Shop primer

Weight: Table

M.B.L:Tension: 500KN

M.B.L:Shear: 420KN

M.B.L:Compression:2000KN